

Hot Off The Plotter

THE NEWSLETTER OF STYCZYNSKI WALKER & ASSOCIATES

Spring Newsletter • February, 2008

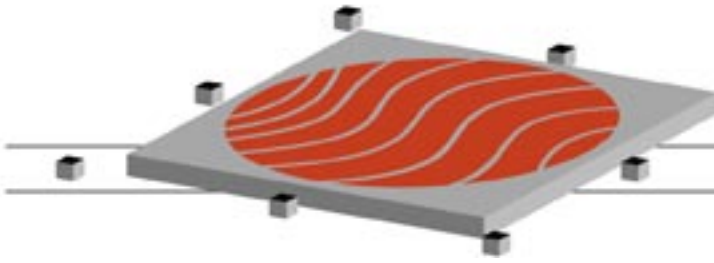

CUSTOM RESIDENTIAL

Wheaton



3-D rendering of the front elevation produced in-house by Manho Lam

Located in an established part of Wheaton, this home presented the challenge of designing an exterior with clean lines and a unique presence, while fitting into the neighborhood. In addition, the owners had some distinctive ideas in how the house should look and feel. Architect Kim Haig collaborated with Doug Walksler at Glen Ellyn Homes to hammer out the many unique details in this home, includ-

ing custom trim and built-in cabinetry in many rooms. Every detail was considered to create a warm and cohesive feeling of simple elegance.

First, to help blend into the surrounding landscape of traditional homes, a large raised front porch was extended across the front of the house with a band of natural stone that wraps around the entire house. Then, a barrel vault ceiling centering on

A great example is cellulose insulation which is composed of almost 100% recycled newspaper, is twice as effective as standard fiberglass insulation, provides a virtually draft free environment and has the added benefit of a great sound deadener.

We can all be more diligent in our daily routines by recycling and reducing energy consumption. As an example, although I have always recycled the dozens of trade publications I receive each month, I have taken the next step by asking to be removed from the mailing list of those I don't read.

At Styczynski Walker & Associates we are prepared to work with builders and ho-

meowners to meet the requirements for EPA Energy Star Homes and the NAHB Green Building Guidelines. I recently attended a two-day course and will earn the NAHB Certified Green Building Professional designation, which is just the beginning of the educational process, as new options for Green Building are appearing daily.

Finally, our Green Home on the Chicago Luxury Home Tour was a huge success. *continued on page 2...*

INSIDE THIS ISSUE:

The Green House	2
Custom Additions	2
Commercial Projects	3
Focus on Technology	3
Addition Award	4
Upcoming Shows	4

A note from Bill

Green Building has finally become mainstream. Virtually every magazine and newspaper features an article on the subject. However, the definition of what is "green" is as varied as the people you talk to. My focus on green building is energy efficiency, resource conservation, indoor air quality and sustainable construction details. A home doesn't necessarily need solar panels or a sod roof to be considered green, although designing and building a home with zero net energy consumption in the Chicago area is a noble venture.

My favorite green features are ones that have mutual benefits for the homeowner.

meowners to meet the requirements for EPA Energy Star Homes and the NAHB Green Building Guidelines. I recently attended a two-day course and will earn the NAHB Certified Green Building Professional designation, which is just the beginning of the educational process, as new options for Green Building are appearing daily.

Finally, our Green Home on the Chicago Luxury Home Tour was a huge success. *continued on page 2...*



THE GREEN HOUSE- completed!

Downers Grove



Front elevation



Great room



Kitchen



Dining room

continued from page 1...

We had over two thousand people visit the house last September, with a lot of positive feedback from attendees. Most found the home warm and inviting, with a comfortable feel. "They could move right in without changing a thing". This is the type of design we strive to provide for all of our clients.

After a whirlwind six months of construction, the Green House (above) was complete, and dressed to impress for the hundreds of visitors that took the Chicago Luxury Home Tour. Although Bill Styczynski is still tweaking the finer details of the house, he is thoroughly delight

should be green. As design professionals, we have a responsibility to use that knowledge!"

CUSTOM ADDITIONS

Westmont



The great room

When Kim Haig first met with this home-owner, a musician, it was evident that the planned addition would have to fulfill a number of unusual requirements. First, the proposed area of the addition would be doubling the size of the house, so it would be a challenge to balance the

new and old so that it formed a cohesive whole. By creating a second wing on the south end of the house and carefully tying in the new roof with the existing roof we were able to blend the two parts of the house into a harmonious composition. Also, the bay window in the new great room added a touch of detail on the front elevation.

Second, with a grand piano, harpsichord and clavichord to be located in the addition, the new rooms had to be carefully arranged to fit the instruments and provide the correct acoustics. By creating a furniture plan early in the process we were able to accommodate all the instruments and furniture groupings in a well-thought out manner.

Finally, the owner had a long wish list of specific requirements that had to be incorporated into the plans. Each item on the list was prioritized to accomplish the optimum balance between need and budget. The general contractor, Chuck Urbasek with Trinity H Construction, managed to create a seamless transition from old to new.

Ultimately, this collaboration between architect, musician and builder provided a new home perfectly attuned to its owner.



The new kitchen

COMMERCIAL PROJECTS

Clarendon Hills



2-D rendering of the street elevation produced in-house by Manho Lam

Located at a prominent corner in downtown Clarendon Hills, this proposed commercial building is set to be an instant landmark. A collaboration by architect, Luka Andjelich and developer John Bell of Waypoint Properties, the building, placed at the corner of Burlington and

Prospect Avenues, addresses the corner with a brick turret, accented with brackets and a copper finial. The brick detail, awnings and stone base will all blend seamlessly into the traditional character of the

BURLINGTON STATION

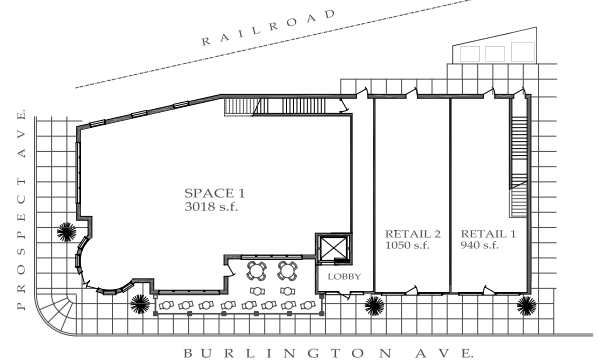

Proposed site plan of Burlington Station downtown.

The 11,900 sf, two-story building is expected to feature a restaurant in the corner space, with several adjoining retail spaces. The second floor will provide over 6,000 sf of office suites.

focus on technology

Kohler generators

In the last few years we've seen a strong trend towards standby home generators. While an initial power outage can create a fun evening of games without the distraction of a TV or a spontaneous romantic night in a candlelit room, power outages lasting for days can cause sump pumps to fail and a freezer of food to spoil. Although a back-up generator can cost \$6,000 or more, a generator will provide the peace of mind that electrical power will be available even if you're not at home.

Architect Bill Styczynski worked with

▼ The Kohler transfer switch feeds the emergency panel electrical loads



Paul Adank of Alternate Technologies to select a Kohler 17KW natural gas generator to provide backup power for his new home. For years, Bill has suggested to clients to that they should include a generator with an automatic transfer switch. This is especially important if you plan to finish the basement. The generator cost should become part of the construction budget. We strive for sustainable design and there is nothing worse than the material waste created from a flooded basement.

Typically, a power outage coincides with significant weather events, including heavy rains or freezing weather, the most inconvenient time to lose power. The generator can be sized to power the entire home or just the essential loads necessary to prevent costly water damage or spoilage of food. Examples of loads to be powered by the generator include sump pumps, ejector pumps, freezers, refrigerators, furnace, boiler, water heaters, microwave oven, stove, and garage door openers. Other additional loads could include the family computer, modem, security system, TV outlet, and selected light fixtures. It is also possible to include an air conditioner if the generator is sized properly.

In contrast to a portable gas generator, a standby generator is much quieter, is per-

manently installed outside the home, and is connected to the home's electrical system utilizing an automatic transfer switch. When a power outage occurs, the natural gas generator will automatically start, and within seconds, begin generating power to selected electrical circuits. When power is restored, the transfer switch will restore power from the utility company and the generator will automatically shut down.

If not installed during the initial construction, conduit, gas lines and a transfer switch should be installed so a generator can easily be added at a later date. Contact Paul Adank at 630-766-7755 x217 or padank@alter-tech.com for more information.



▲ The Kohler 17 KW stand-by generator is ready for any weather related power outage.

AWARD WINNING ADDITION

Naperville



Kitchen

This kitchen and morning room addition, designed by architect Tom Fend, and built by Mike Pudlik of Legacy Design & Construction, was recently awarded First Place by the Chicago NARI, National Association Remodeling Industry.

The entire back of the house was opened up and transformed into an ideal spot for comfortable entertaining. A formerly cramped kitchen and dinette were replaced with a light filled space, embellished with built-in cabinetry and a cathedral ceiling.

Many detailed touches combine to create this warm and inviting kitchen with a feel of traditional elegance.

Large windows, stained and painted woods combined with furniture legs, and soapstone countertops help create the look of a true English kitchen, but with all the modern conveniences.

This plan also relocated the laundry

room, and provided some very useful new spaces,- a mudroom and butler's pantry. Overall, for the small area that was added to the house, the owners gained almost an entirely new first floor, and beautiful spaces that they will enjoy for years to come.

**HOT off the Plotter**

Published by Styczynski Walker & Associates for all our clients, builders, friends and suppliers.

You can contact us at:
Styczynski Walker & Associates
535 Plainfield Road, Suite B
Willowbrook, Illinois 60527
(630) 789-2513
(630) 789-2515 fax
Website: www.swa-architects.com

If you have any questions or comments, or want to be added to our mailing list, contact us in one of the ways shown above.

Editor: Kim Haig
You can email me at kbh@swa-architects.com.

Copyright 2008, Styczynski Walker & Associates

VISIT OUR BOOTH!

Join us for two upcoming shows



Visit Styczynski Walker & Associates and Lifestyle Custom Homes by SWA at booth #512 at the Chicago Home & Garden Show. The show runs from Feb. 29 to March 2 at Schaumburg Convention Center. Free passes are available from our office. For more information, visit www.hbagc.com and look for the yellow flower!



Styczynski Walker & Associates will be at booth #628 at the 6th annual Midwest Builders Show & Conference on March 12-13. The Show will again be located at the Donald E. Stephens Convention Center in Rosemont, IL. This show focuses on providing builders the latest information on products and services. Free passes are available from our office. For more information, visit www.midwestbuildersshow.com.



**STYCZYNSKI
WALKER &
ASSOCIATES**
architects
535 Plainfield Road
Suite B
Willowbrook, IL 60527
630 789-2513